

**vtech**<sup>®</sup>

# Instruction Manual

## Play & Discover Inflatable Car



**VTech understands that a child's needs and abilities change as they grow and with that in mind we develop our toys to teach and entertain at just the right level...**

## **vtech** Baby

**Toys that will stimulate their interest in different textures, sounds and colours**

### **I am...**

...responding to colours, sounds and textures

...understanding cause and effect

...learning to touch, reach, grasp, sit-up, crawl and toddle

**Birth-36 months**



## **Pre-School**

**Interactive toys to develop their imagination and encourage language development**

### **I want...**

...to get ready for school by starting to learn the alphabet and counting

...my learning to be as fun, easy and exciting as can be

...to show my creativity with drawing and music so my whole brain develops

**3-6 years**



## **Electronic Learning Computers**

**Cool, aspirational and inspiring computers for curriculum related learning**

### **I need...**

...challenging activities that can keep pace with my growing mind

...intelligent technology that adapts to my level of learning

...National Curriculum based content to support what I'm learning at school

**4-10 years**



To learn more about this and other VTech® products, visit [www.vtech.co.uk](http://www.vtech.co.uk)

# INTRODUCTION

Thank you for purchasing the **Play & Discover Inflatable Car!**

This cute inflatable car includes lots of interactive features for inside & outside play. Shape sorter lets children pass balls from the outside in or vice versa and detachable electronic driving panel attaches to the car, so your child can learn and role-play all at once!

Inflatable Car ————— Driver Panel



One Car Key



One Self-Discovery  
Mirror



Ten Balls

# INCLUDED IN THE PACKAGE



One Play & Discover Inflatable Car



One Driver Panel



One Air Pump



One Car Key

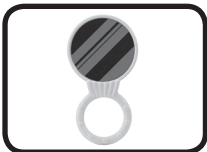

One Mirror



Ten Balls

- Quick Start Guide

## WARNING

All packing materials such as tape, plastic sheets, packaging locks, removable tags, cable ties, cords and packaging screws are not part of this toy and should be discarded for your child's safety.

## NOTE

Please save this Instruction Manual as it contains important information. This package may contain accessories with small parts for adult use only.

**If there are no locks inside the package, disregard this message.  
Removing the Packaging Locks:**

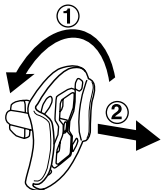

- ① Rotate the packaging locks 90 degrees anticlockwise.
- ② Pull out the packaging locks and discard.

## **WARNING:**

- To ensure your child's safety, adult assembly is required. For your child's safety, do not let your child play with the toy until it is fully assembled.
- Only use under adult supervision. Adult supervision is required at all times. Never leave children unattended.
- Keep uninflated product away from children.
- Do not allow children to play in the product unless fully inflated.
- If over-inflated the toy may rupture. To ensure this doesn't happen make sure there is still some give when squeezed.
- Check frequently to make sure that the air valves are tightly sealed to prevent air leakage.
- Do not use if the product has leaked or is damaged.
- Keep away from sharp objects that could puncture the product.
- Do not attach items that are not specifically designed to be used with the product that could cause strangulation hazards (i.e. strings, cables, ties...)
- For indoor use only.
- This is not an aquatic toy. Do not use in water.
- To avoid drowning hazards do not fill the car with water.
- Do not place inflatable near any potential fire hazards or open flames.
- Please ensure there are no foreign objects in the inflatable's immediate surroundings. Parents should stop children leaning to far out of the inflatable and stop any movements that may cause the inflatable to tip and become a hazard. Do not place the inflatable at height. Place the inflatable on a soft floor. Do not place it on a bed or other raised level to avoid a fall hazard.

# INSTRUCTIONS

## BATTERY REMOVAL AND INSTALLATION

1. Make sure the unit is turned OFF.
2. Locate the battery cover on the back of the driver unit. Use a screwdriver to loosen the screw and then open the battery cover.
3. If used batteries are present, remove these batteries from the unit by pulling up on one end of each battery.
4. Install 2 new AAA (AM-4/LR03) batteries following the diagram inside the battery box. (For best performance, alkaline batteries or fully charged Ni-MH rechargeable batteries are recommended.)
5. Replace the battery cover and tighten the screw to secure.

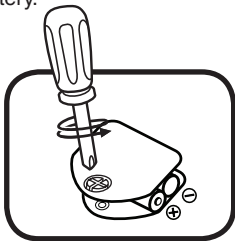

### WARNING:

Adult assembly required for battery installation.  
Keep batteries out of reach of children.

### IMPORTANT: BATTERY INFORMATION

- Insert batteries with the correct polarity (+ and -).
- Do not mix old and new batteries.
- Do not mix alkaline, standard (carbon-zinc) or rechargeable batteries.
- Only batteries of the same or equivalent type as recommended are to be used.
- Do not short-circuit the supply terminals.
- Remove batteries during long periods of non-use.
- Remove exhausted batteries from the toy.
- Dispose of batteries safely. Do not dispose of batteries in fire.

## RECHARGEABLE BATTERIES:

- Remove rechargeable batteries from the toy before charging.
- Rechargeable batteries are only to be charged under adult supervision.
- Do not charge non-rechargeable batteries.

## Disposal of batteries and product



The crossed-out wheellie bin symbols on products and batteries, or on their respective packaging, indicates they must not be disposed of in domestic waste as they contain substances that can be damaging to the environment and human health.

The chemical symbols Hg, Cd or Pb, where marked, indicate that the battery contains more than the specified value of mercury (Hg), cadmium (Cd) or lead (Pb) set out in the Batteries and Accumulators Regulation.



The solid bar indicates that the product was placed on the market after 13th August, 2005.

Help protect the environment by disposing of your product or batteries responsibly.

## **VTech® cares for the planet.**

Care for the environment and give your toy a second life by disposing of it at a small electricals collection point so all its materials can be recycled.

### **In the UK:**

Visit [www.recyclenow.com](http://www.recyclenow.com) to see a list of collection points near you.

### **In Australia & New Zealand:**

Check with your local council for kerbside collections.

# ASSEMBLY INSTRUCTIONS

With the **Play & Discover Inflatable Car**, safety comes first. To ensure your child's safety, adult assembly is required.

## Inflatable Car

1. Use the Air Pump to inflate the car fully. There are two hooks on the inside front of the car, fix the **Driver Panel** to the hooks and secure by pulling down, you can hear it click into place.

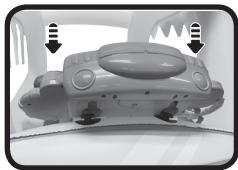

## Basketball Play

To change the steering wheel to basketball play, push the change switch (located on the back of the steering wheel) up, then pull the steering wheel down until you hear it click. This locks the basketball ring into place. Reverse this method to change back to the steering wheel.

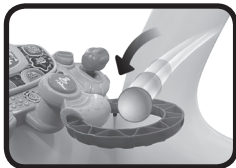



# PRODUCT FEATURES

## 1. ON/OFF Switch

To turn the panel **ON**, slide the **On/Off/Switch** to the **ON** (☺) position.

To turn the panel **OFF**, slide the **On/Off Switch** to the **OFF** (●) position.

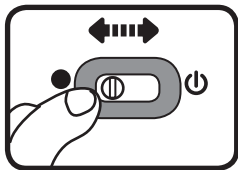

## 2. Automatic Shut-Off

To preserve battery life, the **Driving Panel** will automatically power-down after approximately 60 seconds without input. The panel can be turned on again by pressing the light up buttons or horn button, turning the steering wheel/pressing the basket and pulling/pushing the gear shift.

**NOTE:** If the unit powers down or the light fades out during play, we suggest changing the batteries.

## How to use the air pump:

### WARNING:

This pump is not a toy. It may release small parts which pose a choking hazard. Adult operation only. Keep it out of the reach of children.

1. Attach the end of the pipe to one of the valve stems on the inflatable car, press/push the pump to inflate the car, make sure the car is inflated using all three valves. Ensure the car is fully inflated.

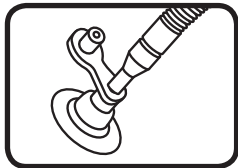

2. Take the pipe out and replace the cap on the air valve. Then push the valve in so it's flush with the main surface.

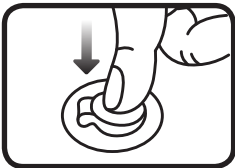
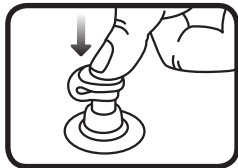

3. Deflate the car when not in use. Pull up the air valve and squeeze the valve stem to deflate, make sure all three valves are open to deflate.

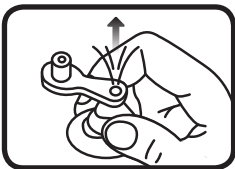
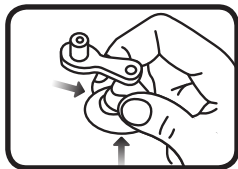

## ACTIVITIES

### Driving Panel

#### 1. On/Off Switch

To turn the panel **On**, slide the **On/Off Switch** to the **On** position, you will hear a song, phrases and fun sounds. The light pattern will flash with the sounds.

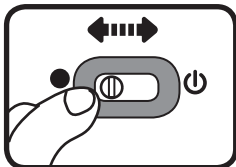

#### 2. Ignition Key Slot

Turn the key slot with or without the key accessory to choose different modes (Explore/Music/Learn) and hear songs, phrases and fun sounds. The light pattern will flash with the sounds.

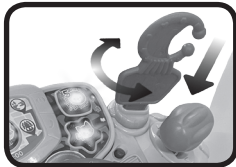

### 3. Light Up Buttons

Press the **Light Up Buttons** to learn numbers, shapes, animals and music. The light pattern will flash with the sounds.



### 4. Steering Wheel

Turn the **Steering Wheel** for pretend driving play and to trigger fun driving sounds and music. The light pattern will flash with the sounds.



### 5. Basketball Hoop

Press the **Basketball Hoop** to hear playful sounds. The light pattern will flash with the sounds.



## ACTIVITIES

### Inflatable Car

#### 1. Driving play

Attach the panel to the car to play role play driving fun.



#### 2. Basketball play

Change the steering wheel to a basketball hoop, insert the balls to play basketball.

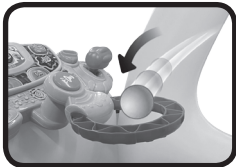

# MELODIES

1. Ants Go Marching
2. A-Tisket A-Tasket
3. Bingo
4. Did You Ever See a Lassie?
5. Dill Pickles
6. Girls and Boys Come Out to Play
7. Yankee Doodle
8. Hickory Dickory Dock
9. Hot Cross Buns
10. London Bridge
11. Incy Wincy Spider
12. Little Miss Muffet
13. Old King Cole
14. One Man Went to Mow a Meadow
15. Oranges and Lemons

# SONG LYRICS

## Song 1

Hello, my friend hop on for a drive,  
Let's play some music and have a sing-along.

## Song 2

The wheels on the car go round and round,  
Join us now, for a drive,  
Let's explore the world today,  
With lots of animal fun.

## Song 3

1-2-3 let's go go go,  
ABC let's zoom to and fro!

# CARE & MAINTENANCE

1. Keep the unit clean by wiping it with a slightly damp cloth.
2. Keep the unit out of direct sunlight and away from any direct heat sources.
3. Remove the batteries if the unit will not be in use for an extended period of time.
4. Do not drop the unit on hard surfaces and do not expose the unit to moisture or water.

## Cleaning and storing for Inflatable Car

1. After deflation, use a damp cloth to gently clean all surfaces.  
Note: Never use solvents or other chemicals that may damage the product.
2. Store in a cool, dry place and out of children's reach.
3. Check the product for damage at the beginning of each play session and at regular intervals when in use.

# TROUBLESHOOTING

If for some reason the unit stops working or malfunctions, please follow these steps:

1. Turn the unit **Off**.
2. Interrupt the power supply by removing the batteries.
3. Let the unit sit for a few minutes, then replace the batteries.
4. Turn the unit **On**. The unit should now be ready to play with again.
5. If the unit is not working properly, install a brand new set of batteries.

If the problem persists, please contact our Consumer Services Department, and a service representative will be happy to help you.

# CONSUMER SERVICES

Creating and developing VTech® products is accompanied by a responsibility that we at **VTech®** take very seriously. We make every effort to ensure the accuracy of the information, which forms the value of our products. However, errors sometimes can occur. It is important for you to know that we stand behind our products and encourage you to call our Consumer Services Department with any problems and/or suggestions that you might have. A service representative will be happy to help you.

## **UK Customers:**

Phone: 0330 678 0149 (from UK) or +44 330 678 0149 (outside UK)

Website: [www.vtech.co.uk/support](http://www.vtech.co.uk/support)

## **Australian Customers:**

Phone: 1800 862 155

Website: [support.vtech.com.au](http://support.vtech.com.au)

## **NZ Customers:**

Phone: 0800 400 785

Website: [support.vtech.com.au](http://support.vtech.com.au)

# PRODUCT WARRANTY/ CONSUMER GUARANTEES

## **UK Customers:**

Read our complete warranty policy online at [vtech.co.uk/warranty](http://vtech.co.uk/warranty).

## **Australian Customers:**

VTECH ELECTRONICS (AUSTRALIA) PTY LIMITED –  
CONSUMER GUARANTEES

Under the Australian Consumer Law, a number of consumer guarantees apply to goods and services supplied by VTech Electronics (Australia) Pty Limited. Please refer to [vtech.com.au/consumerguarantees](http://vtech.com.au/consumerguarantees) for further information.

**Visit our website for more  
information about our products,  
downloads, resources and more.**

***www.vtech.co.uk***  
***www.vtech.com.au***

